



**FITTING INSTRUCTIONS FOR FI0118 FRAME INSERTS**  
**MV AGUSTA 800 TURISMO VELOCE '15-**



**THIS KIT CONTAINS THE ITEMS PICTURED AND LABELLED BELOW.**  
**DO NOT PROCEED UNTIL YOU ARE SURE ALL PARTS ARE PRESENT.**

**Please note that the way the kit is packed does not necessarily represent the way of mounting to the bike**

Please note that in cases where kits are packed with a plastic tube separating components on the spindle bar (this tube should be discarded).

THE PARTS SHOWN MAY BE REPRESENTATIVE ONLY (FOR CLARITY OF INSTRUCTIONS ONLY)

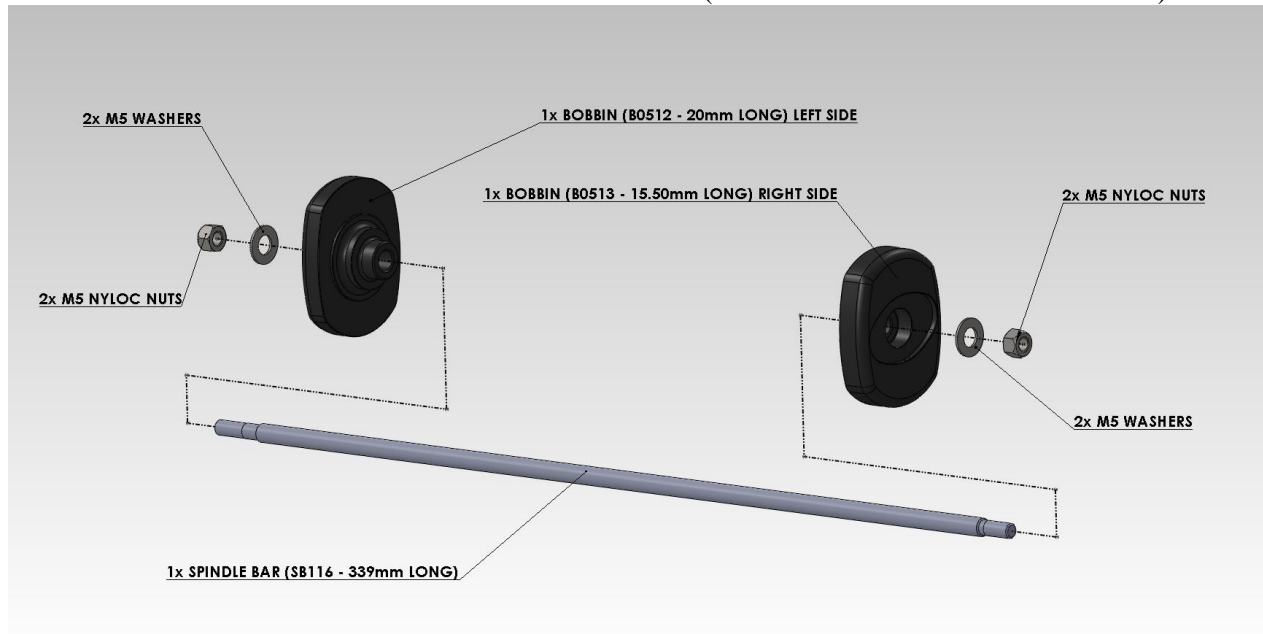



### **TOOLS REQUIRED**

- Socket set to include 2x 8mm sockets and wrenches

### **FITTING INSTRUCTIONS**

- Fit one nut and washer onto the spindle bar and engage one nut so the plastic insert of the nut is fully engaged.
- Feed the spindle bar with the nut and washer fitted through the thicker frame insert (B0512) so the nut and washer go into the counter bore of the frame insert.
- Feed this assembly through the frame/swingarm pivot from the left hand side of bike.
- Place the remaining thinner frame insert over the exposed end of the spindle bar on the other side of the bike.
- Fit the remaining washer and nut from the kit onto the exposed thread and tighten until both nuts are engaged in the nylon and equal amounts protrude from either side. *Do not overtighten – the nyloc nuts will hold it tight.*
- Fit the bubble stickers into the recess on both frame inserts.

ISSUE 1 13/08/2015 (AR)

### **CONSUMER NOTICE**

The catalogue description and any exhibition of samples are only broad indications of the Products and R&G may make design changes which do not diminish their performance or visual appeal and supplying them in such state shall conform to the order. The Buyer acknowledges no representation or warranty (other than as to title) has been given or will apply to the Products other than those in R&G's order or confirmation and the Buyer confirms it has chosen the Products as being of merchantable quality and suitable for its particular purposes. Where R&G fits the Products or undertakes other services it shall exercise reasonable skill and care and rectify any fault free of charge unless the workmanship has been disturbed. The Buyer is responsible for ensuring that the warranty on the motorcycle is not affected by the fitting of the Products. On return of any defective Products R&G shall at its option either supply a replacement or refund the purchase money but shall not be liable if the Products have been modified or used or maintained otherwise than in accordance with R&G's or manufacturer's instructions and good engineering practice or if the defect arises from accident or neglect. Other than identified above and subject to R&G not limiting its liability for causing death and personal injury, it shall not be liable for indirect or consequential loss and otherwise its liability shall be limited to the amounts paid by the Buyer for the Products or the fitting or service concerned. These terms do not affect the Buyer's statutory rights.

### **R&G RACING RETURNS POLICY (NON-FAULTY GOODS)**

Returns must be pre-authorized (if not pre-authorized the return will be rejected). Goods may only be returned direct to us if they were purchased direct from us (customer must prove if necessary). Otherwise to be returned to original vendor. Goods must be in resellable condition, in the opinion of R&G Racing. All returns are subject to a 25% restocking and handling fee (25% of the gross value exc. P&P – at the prevailing price at time of purchase). The customer must pay any and all carriage charges. No returns of discontinued products, unless within 14 days of purchase. This policy does not affect your statutory rights and does not refer to faulty goods.



**INSTRUCTIONS DE MONTAGE POUR FI0118 INSERTS CADRE**  
**MV AGUSTA 800 TURISMO VELOCE '15-**



**Le kit contient les articles exposés ci-dessous, vérifier que toutes les pièces soient présentes avant de procéder au montage.**

**LA FAÇON DONT LE KIT EST EMBALLE NE CORRESPOND PAS FORCEMENT A LA FAÇON DE MONTER LES PIECES SUR LA MOTO.**

Notez que si les kits sont emballés avec un tube en plastic qui sépare les composants sur l'axe, ce tube doit être jeté.  
**LES PARTIES PRESENTEES PEUVENT ETRE UNIQUEMENT REPRESENTATIVES (POUR LA CLARTE DES INSTRUCTIONS UNIQUEMENT.)**

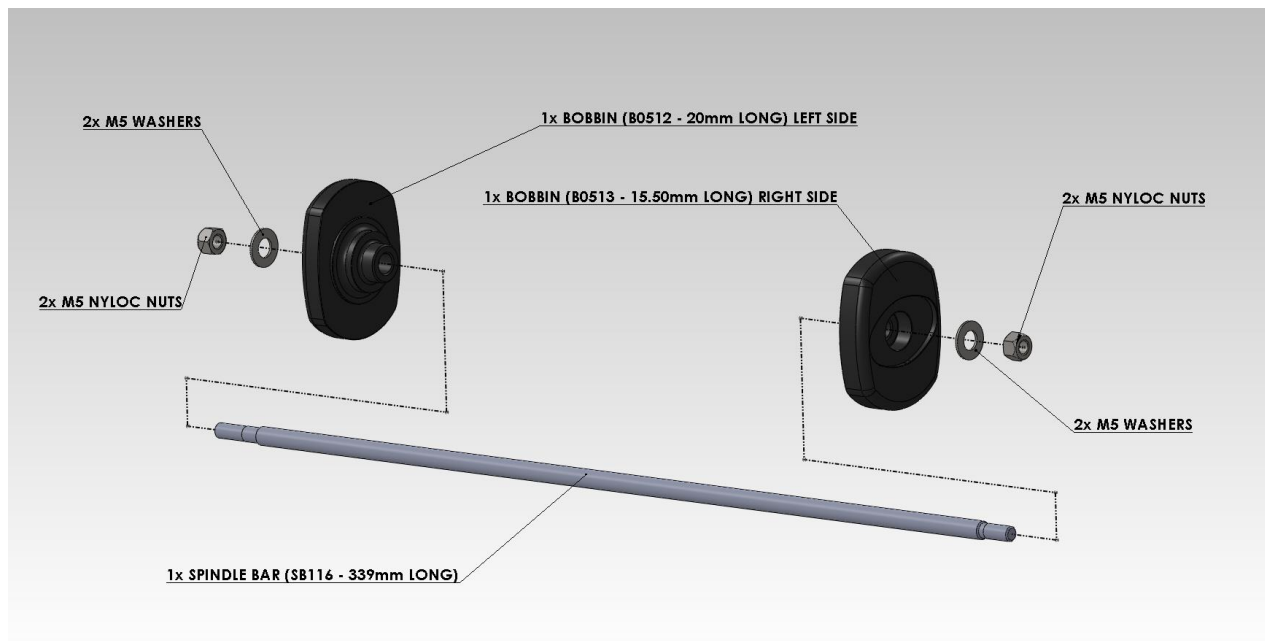



### **OUTILS REQUIS**

- Jeu de clés à douille 2x 8mm

### **INSTRUCTIONS DE MONTAGE**

- Passer un écrou et une rondelle sur l'axe, puis engager l'écrou pour que l'insert de plastic de l'écrou soit complètement engagé.
- Passer l'axe avec écrou et rondelle à travers l'insert de cadre le plus épais (B0512) pour que l'écrou et la rondelle aillent dans le contre alésage dans l'insert de cadre.
- Passer l'ensemble à travers le cadre/ pivot de bras oscillant du coté gauche de la moto
- Placer l'insert de cadre fin restant autour de l'extrémité de l'axe de l'autre coté de la moto.
- Passer la rondelle et l'écrou du kit sur le filetage et serrer jusqu'à ce que les 2 écrous soient engagés dans le nylon et que les longueurs dépassantes de chaque coté soient égales. Ne pas trop bloquer, les écrou fixent l'ensemble correctement.
- Placer les stickers de caoutchouc dans le creux des 2 inserts de cadre.

ISSUE 1 13/08/2015 (AR)

### **CONSUMER NOTICE**

The catalogue description and any exhibition of samples are only broad indications of the Products and R&G may make design changes which do not diminish their performance or visual appeal and supplying them in such state shall conform to the order. The Buyer acknowledges no representation or warranty (other than as to title) has been given or will apply to the Products other than those in R&G's order or confirmation and the Buyer confirms it has chosen the Products as being of merchantable quality and suitable for its particular purposes. Where R&G fits the Products or undertakes other services it shall exercise reasonable skill and care and rectify any fault free of charge unless the workmanship has been disturbed. The Buyer is responsible for ensuring that the warranty on the motorcycle is not affected by the fitting of the Products. On return of any defective Products R&G shall at its option either supply a replacement or refund the purchase money but shall not be liable if the Products have been modified or used or maintained otherwise than in accordance with R&G's or manufacturer's instructions and good engineering practice or if the defect arises from accident or neglect. Other than identified above and subject to R&G not limiting its liability for causing death and personal injury, it shall not be liable for indirect or consequential loss and otherwise its liability shall be limited to the amounts paid by the Buyer for the Products or the fitting or service concerned. These terms do not affect the Buyer's statutory rights.

### **R&G RACING RETURNS POLICY (NON-FAULTY GOODS)**

Returns must be pre-authorized (if not pre-authorized the return will be rejected). Goods may only be returned direct to us if they were purchased direct from us (customer must prove if necessary). Otherwise to be returned to original vendor. Goods must be in resellable condition, in the opinion of R&G Racing. All returns are subject to a 25% restocking and handling fee (25% of the gross value exc. P&P – at the prevailing price at time of purchase). The customer must pay any and all carriage charges. No returns of discontinued products, unless within 14 days of purchase. This policy does not affect your statutory rights and does not refer to faulty goods.